

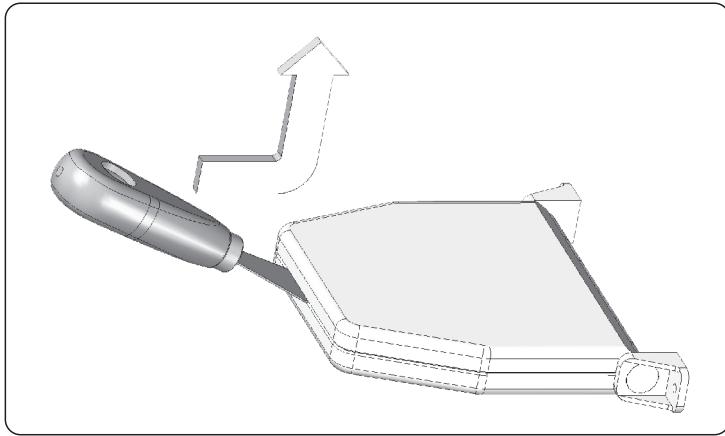

## **ASSEMBLY INSTRUCTION**

### **STRAP RETRACTOR**





1. In order to open the tape retractor housing, flat screwdriver (preferably a spatula) should be inserted into the gaps in the front part of the casing, and evenly

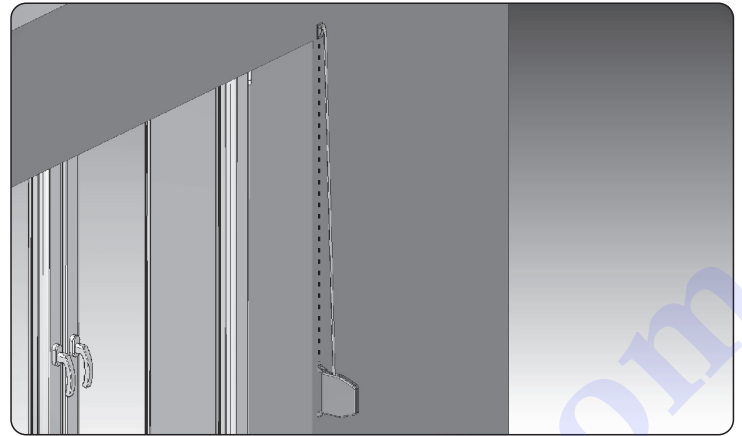

2. The retractor should be screwed on to the wall, vertically in relation to the exit of the strap with a grommet.

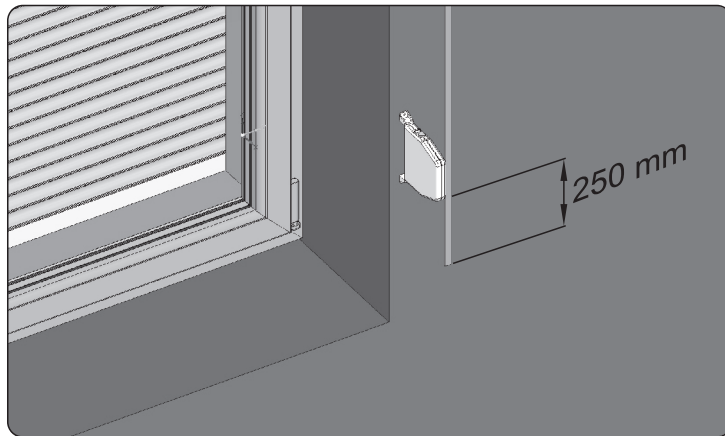

3. Lower the blind shutter armor, then cut the tape to a length of 250 mm below the assembly site of the retractor.

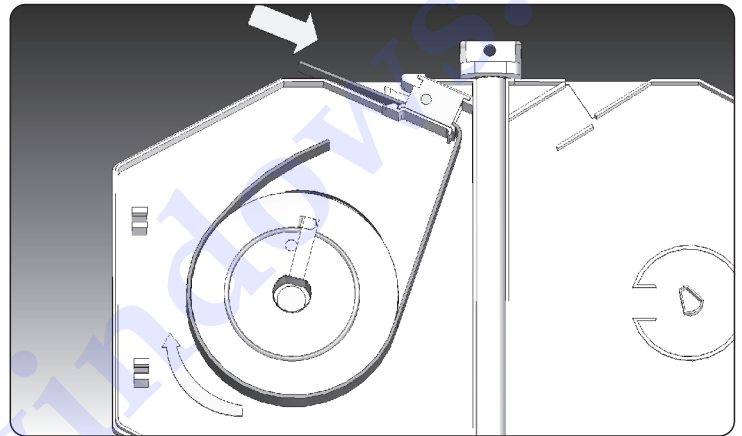

4. Insert the strap into the hole under the brake and drag the tape under the spool.

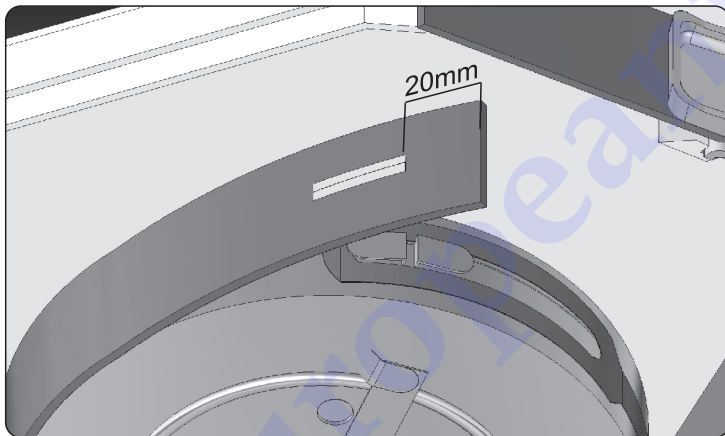

5. Slits the strap approx. 20 mm from the edge of the tape.

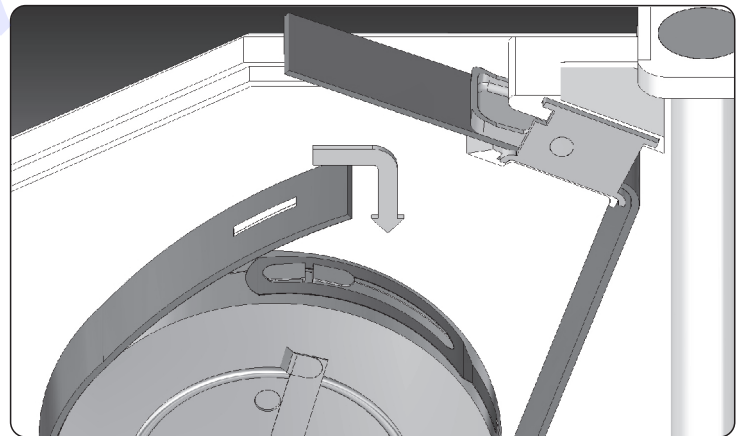

6. End the tape to the hook that protrudes from the reel spool.

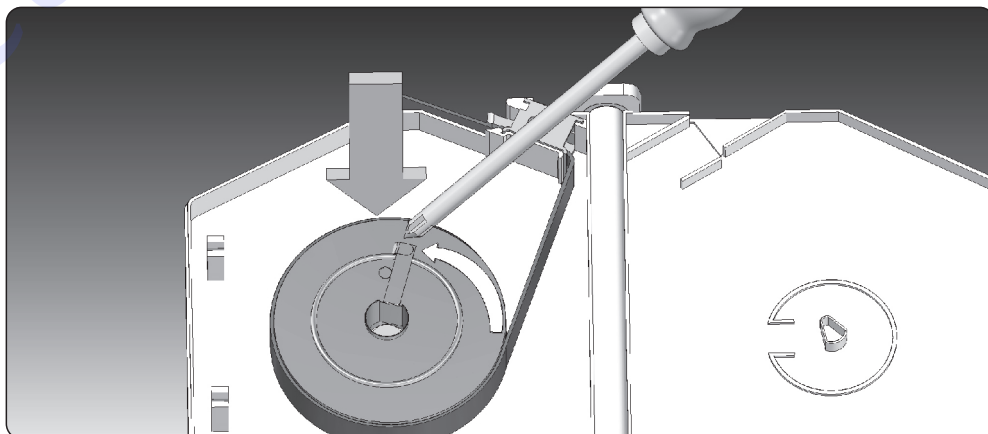

7. Undo the reels. Use a screwdriver to press the locks and allow the strap to be wind back automatically